

MODELS WT, WT-B and WJ-228

INSTALLATION AND MAINTENANCE INSTRUCTIONS

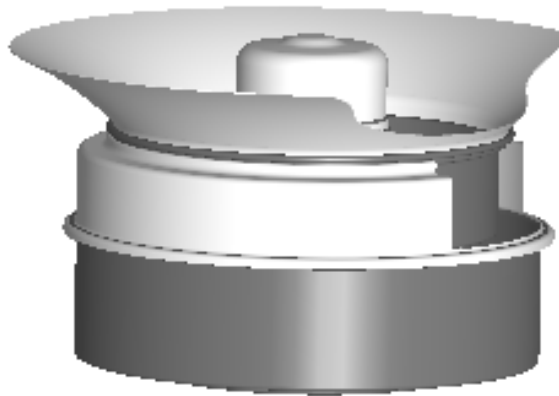

These installation instructions have been provided to assist the installer in making a good installation. Inside you will find a step by step typical installation, pictured in road map fashion for your convenience. With a few exceptions models WT and WJ-228 are identical in installation procedures. Any differences are outlined in the specification table on page 4. Please familiarize yourself with these instructions before installing your Humidity Source Quality Humidifier.

APPLICATION

The model WT and WJ-228 humidifiers have been designed to discharge the mist directly into the air stream of either supply or return ducts. Check to insure that the air in the duct has a high enough temperature and low enough humidity to allow for complete absorption of the mist. Reduce output if necessary.

Minimum air flow requirements for proper operation are:

WT	2000 CFM
WJ-228	1200 CFM

Humidity Source positive capacity atomizing humidifiers produce moisture that will quickly evaporate in the air duct if there is no impingement of water particles against barrier surfaces before the vapor is completely absorbed. It is important that minimum clearance be adhered to as shown in these installation instructions to prevent any condensation from forming in the duct.

Typical Installation For Models WT, WT-B and WJ-228

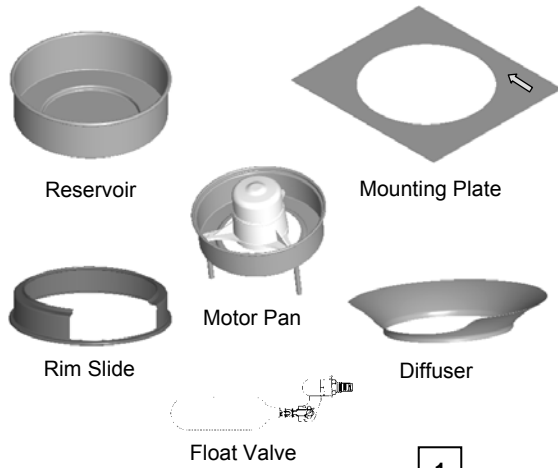

Remove humidifier components from box and identify them.

1

The examples shown below are based on air velocity in the duct of 800 ft/min. For increased velocities add 1' to the minimum obstruction distance for each 100ft/min. Distances based on 65 deg. F and 30% R.H. max.

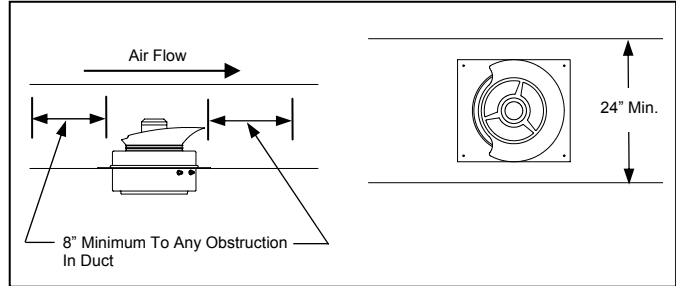

Minimum duct height: WT 16", WJ-228 14"

Minimum duct width: 24"

Note direction of air flow. Establish minimum duct size and minimum straight run requirements before proceeding.

2

18" X 11" access cut out.

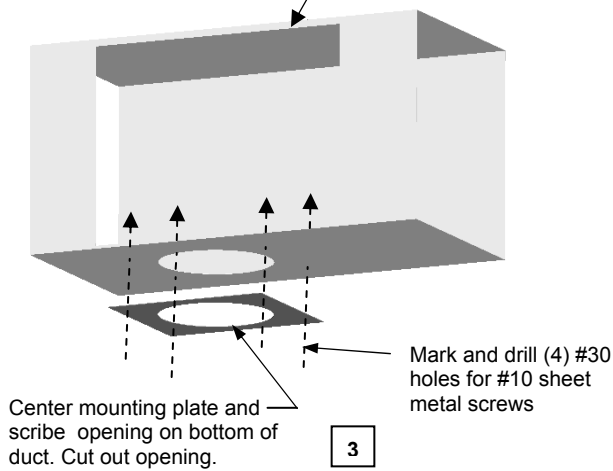

3

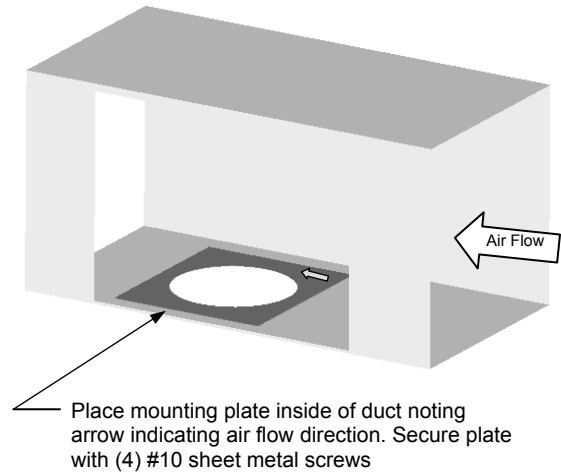

4

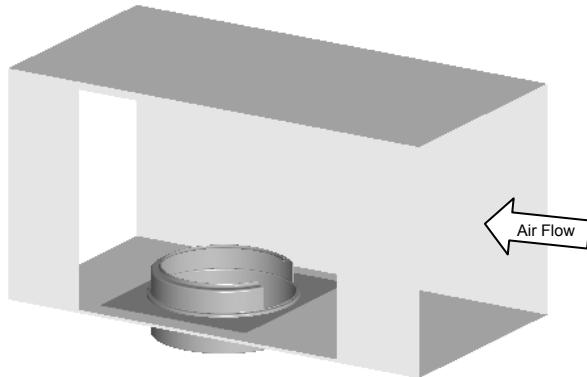

Insert reservoir and rim slide. Turn the reservoir so that the air flow markings are in line with the arrow on the mounting plate and the rim slide slot faces the direction of air flow.

5

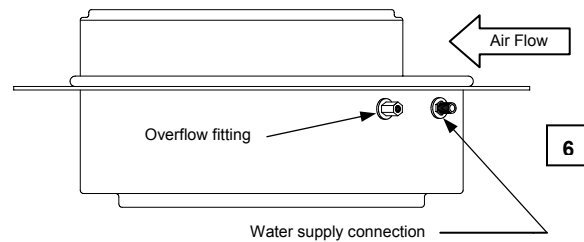

6

Water connections

Insert float valve assembly (see Fig 1) and over flow connection with washers on the outside of the reservoir. Connect a water line to 1/8" MPT on the float valve and if overflow is necessary connect to the 1/4" FPT overflow fitting. Flush water line of impurities before making the water line connection to the float valve. Turn on the water supply and adjust the water level to 1/2" below the overflow fitting. See Fig 1 for float valve adjustments.

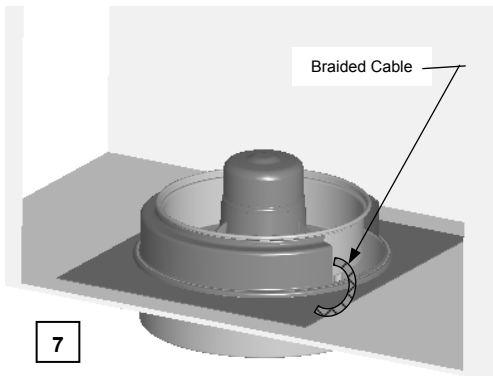

7
 Insert atomizer unit into reservoir making sure it is centered and the float valve is clear of the motor pan legs and moves freely. Position the braided cable so that it extends from the left side of the slot and through the hole on the mounting plate.

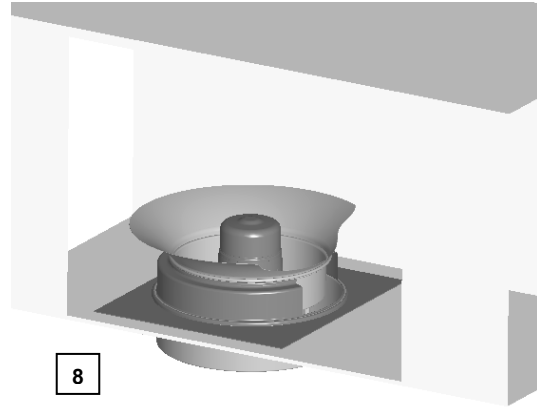

8
 To complete the installation insert diffuser and position as shown with open gap facing air flow. Be sure diffuser is properly seated. Refer to the electrical diagram below for power connections.

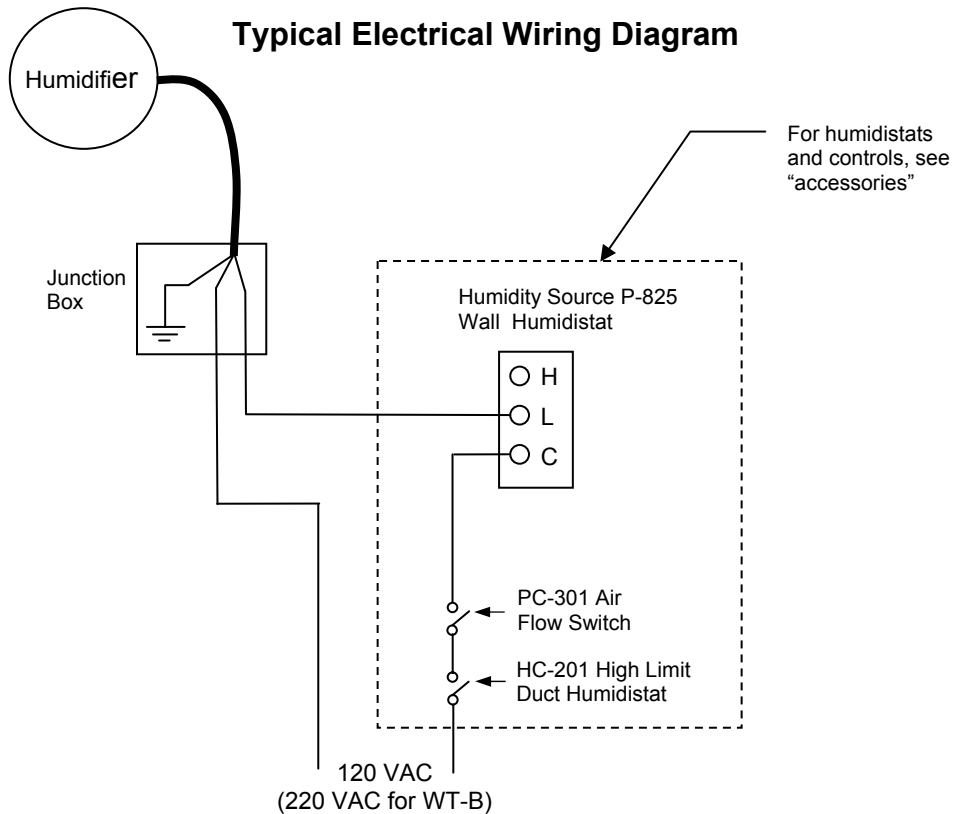
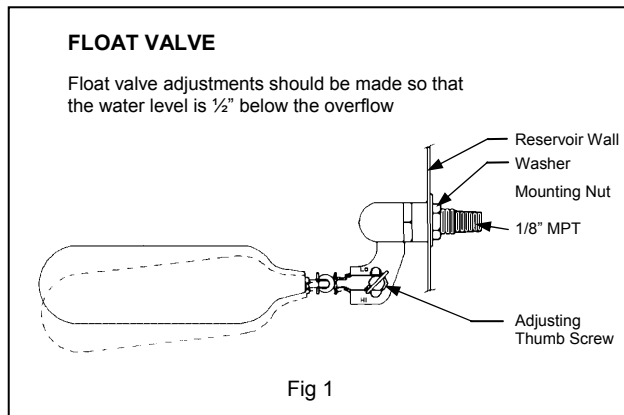

Specifications for Models WT/WT-B and WJ-228

	<u>WT</u>	<u>WJ</u>
"A" Dimension	19"	19"
"B" Dimension	17"	17"
"C" Dimension	14 9/16"	12 13/16"
"D" Dimension	12 3/8"	9 7/8"
"E" Dimension	4 3/8"	4"
Duct Height	16" Min.	14" Min.
Duct Width	24" Min.	24" Min.
Access Panel Size	18" x 11"	18" x 11"
Power Required	1 ph. 50/60 Hz 115v (WT)	1 ph. 50/60 Hz 115v
	1ph. 50/60 Hz 230v (WT-B)	
Power Consumption	132 watts (WT)	90 watts
	127 watts (WT-B)	
Operating Weight	37 lbs.	29 lbs.
Operating Water Pressure	10-100 psig	10-100 psig

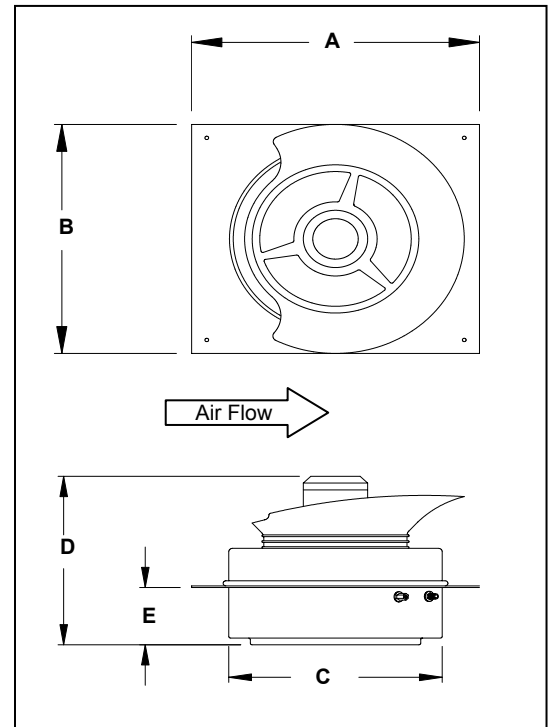

MAINTENANCE

Cleaning Of The Atomizing Unit

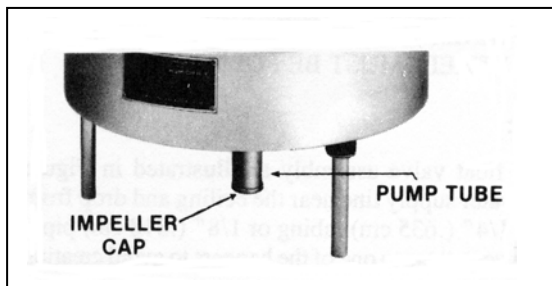

All natural water systems have a certain amount of water solids which will accumulate in the atomizing unit of your humidifier. Over time this accumulation will reduce the efficiency and out-put of the humidifier. When this happens it will be necessary to clean the atomizing unit pump tube.

Before cleaning be sure to disconnect electrical power from the humidifier. Carefully lift atomizing unit out of reservoir. To remove the impeller cap, hold a flat file or the back of a table knife flat against the side of the tube and gently tap the cap which is held in place by a pressed fit. After the cap has been removed, the inside of the tube is visible and it is simple matter to clean it with a piece of cloth on the end of a screwdriver or a small round brush.

There are three ports through which water makes its way from the pump tube to the top of the rotating disc. These ports should be cleaned out with the aid of a wire.

Replace the impeller cap by tapping it evenly back into place, using plastic handle on screwdriver.

Inspect float valve assemble periodically, & replace when necessary, or every few years. Should this humidifier need service or repair some time in the future, return only atomizing unit direct to the factory.